

FACT SHEET



Hotel Information

4 star superior hotel, both elegant and contemporary in its style

Location

- Located in the breathtaking waterfront of Liverpool's City centre
- 7 miles from John Lennon International Airport
- 10 minutes walk from Lime Street train station
- Within easy reach of Liverpool's main tourist attractions, including Liverpool and Everton football clubs, The Beatles Museum, art galleries, historical museums, the Albert's Dock, Aintree race course and shopping and theatre districts.

Rooms

- 194 stylish guest rooms in Ocean and Urban Styles including Business Class rooms, 4 Junior Suites, Luxurious River Suite
- In room amenities include; complimentary internet access, TV, pay movies, direct dial telephone, hairdryer, iron and ironing board, tea/coffee making facilities, minibar, individual climate control, dry cleaning and laundry service, separate bath and shower

Food & Beverage

- Filini Restaurant with striking views over the River Mersey serves up a whole new food philosophy as its menu innovatively blends Sardinian flavours with Mediterranean classics
- Super Buffet Breakfast
- The White Bar Lounge and cocktail Bar serves light meals, fine wines, beers and delectable cocktails all in contemporary surroundings

Fitness & Relaxation

The Ark Health & Fitness Club offers a place to relax, Unwind or work out. Facilities includes

- Precor gymnasium, Dance studio
- Pool, Sauna, Steam room, Whirlpool
- Solarium

Meetings & Events

- 9 meeting rooms all with natural day light
- Largest room can hold up to 180 delegates theatre style and can be divided into 3 separate sections with a spacious pre function area directly outside.
- State of the art equipment in all meeting rooms
- Fully air-conditioned
- Complimentary internet access throughout the hotel for hotel guests

Radisson SAS Hotel

107 Old Hall Street, Liverpool, L3 9BD, United Kingdom

Tel: +44 (0) 151 966 1500, Fax: +44 (0) 151 966 1501

info.liverpool@radissonsas.com

liverpool.radissonsas.com

Conference & Meeting Facilities

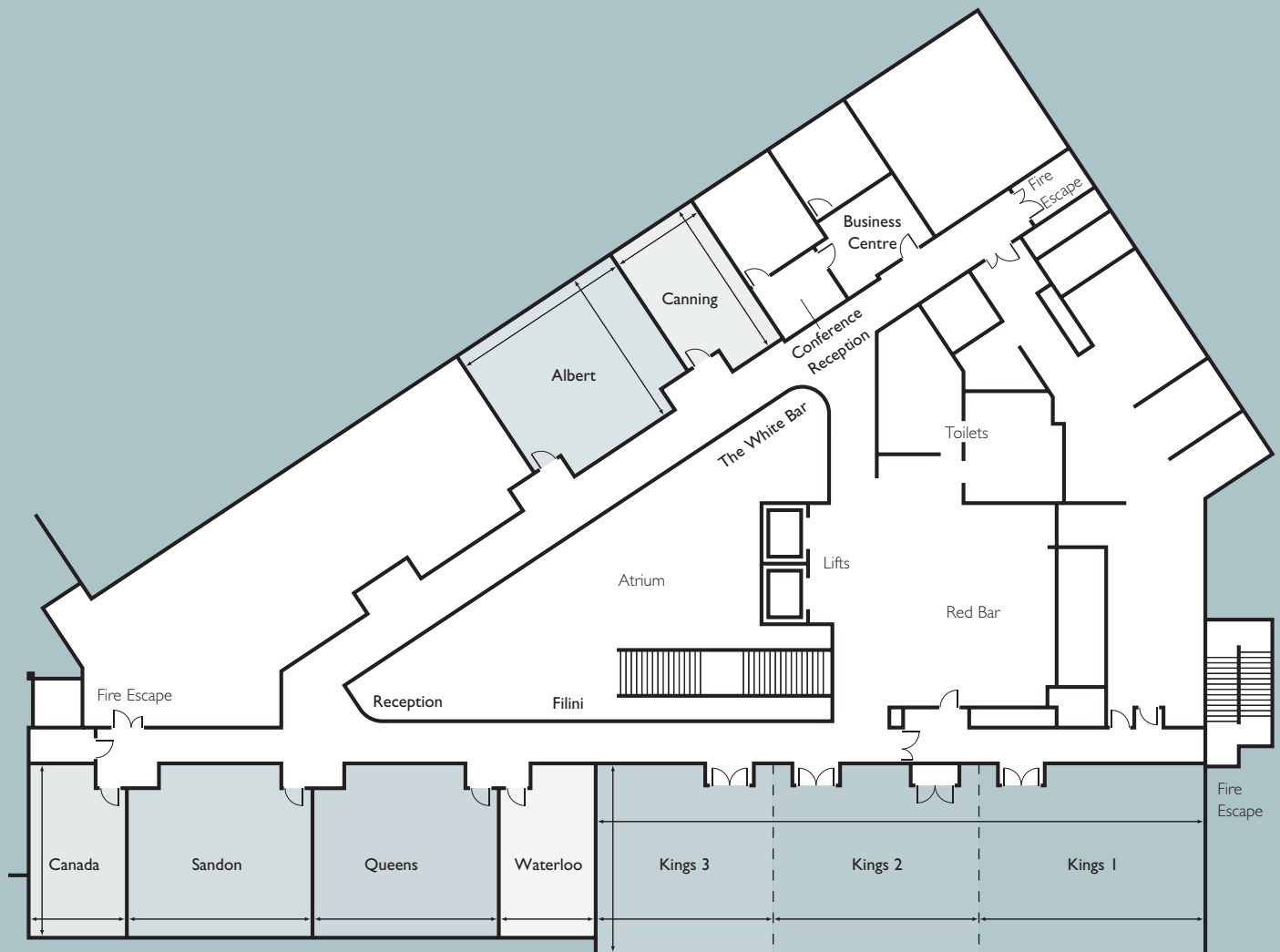

	Boardroom	Banquet	Classroom	U-Shape	Theatre	Reception	Cabaret	Ceiling Height	Length x Width	Square metres	Full Day	Half Day
Kings 1+2+3	N/A	130	120	N/A	180	200	90	3.4	25 x 7.25 m	181	£ 1,700	£ 1,100
Kings 1	28	45	40	24	60	60	24	3.4	10 x 7.25	72	£ 700	£ 455
Kings 2	20	40	24	25	40	40	24	3.4	7.6 x 7.25	55	£ 500	£ 325
Kings 1+2	44	80	60	45	110	100	70	3.4	17.5 x 7.25	127	£ 1,200	£ 780
Kings 3	18	40	36	12	50	40	24	3.4	7.5 x 7.25	54	£ 500	£ 325
Kings 2+3	40	70	50	40	100	90	60	3.4	15 x 7.25	108	£ 1,000	£ 650
Queens	20	40	24	18	50	50	28	3.4	7.8 x 7.25	57	£ 400	£ 300
Sandon	20	40	24	18	50	50	28	3.4	7.8 x 7.25	57	£ 400	£ 300
Albert	20	40	24	18	40	40	28	3.4	7.8 x 6.5	51	£ 400	£ 250
Canada	12	N/A	6	N/A	15	N/A	N/A	3.4	4 x 7.25	29	£ 200	£ 150
Canning	12	N/A	6	N/A	15	N/A	N/A	3.4	3.9 x 6.5	23	£ 200	£ 150
Waterloo	12	N/A	6	N/A	15	N/A	N/A	3.4	3.9 x 7.25	28	£ 200	£ 150